

True Union Ball Valve Type 375



Technical Features

- New and improved ergonomic handle
- Aesthetically improved body and nuts
- NSF 61 Certified
- Full port design
- Compact length
- 10,000 life cycle
- Blow-out proof stem
- Fully serviceable and adjustable seat carrier
- Double stem seals
- Floating ball design

Type 375 True Union Ball Valve

PVC/CPVC

Size range 3/8"–6"
End Connections Socket
 Female NPT
 *3/8"–2" include both socket and FNPT ends
Seals EPDM, FPM
Seat PTFE

PVC Part Numbers

Size (inch)	Socket/Threaded ¹		Flanged	
	EPDM	FPM	EPDM	FPM
3/8	161 375 001	161 375 016	N/A	
1/2	161 375 002	161 375 017	161 375 062	161 375 077
3/4	161 375 003	161 375 018	161 375 063	161 375 078
1	161 375 004	161 375 019	161 375 064	161 375 079
1 1/4	161 375 005	161 375 020	161 375 065	161 375 080
1 1/2	161 375 006	161 375 021	161 375 066	161 375 081
2	161 375 007	161 375 022	161 375 067	161 375 082
2 1/2 ¹	161 375 008	161 375 023	161 375 068	161 375 083
3 ¹	161 375 009	161 375 024	161 375 069	161 375 084
4 ¹	161 375 010	161 375 025	161 375 070	161 375 085
6 ¹	161 375 011	161 375 026	161 375 071	161 375 086

¹ Socket ends only supplied from 2 1/2"–6."

Specification

All PVC or CPVC Ball Valves sizes 3/8"–6" (CPVC 1/2"–2") shall be of True Union design with two-way blocking capability. As a safety feature, the valves shall have a blow-out proof stem with double stem seals. All O-rings shall be either EPDM or FPM and the valve seats shall be PTFE with an elastomeric backing of the same material as the valve seals. The valve shall be of floating ball design with full schedule 80 bore (except for 6" venturied). All ball valves shall have an adjustable seat carrier that can be adjusted

or removed using the valve handle as a spanner wrench. On sizes 3/8"–2", all ball valves shall be supplied with both socket and threaded end connectors. All PVC ball valves shall be NSF 61 certified for potable water use. PVC shall conform to ASTM D1784, classification 12454-B. CPVC shall conform to ASTM D1784, classification 23447-B. The valve Type 375 shall have a pressure rating up to 225 psi at 68°F as supplied by Georg Fischer LLC, Tustin, CA, or Georg Fischer Sloane LLC, Little Rock, AR.

Dimensions PVC and CPVC

Size inch	D1 in	D2 in	L in	Z in	J in	H in	M in	S in	B in	Approx. Wt Lbs	
										PVC	CPVC
1/2	1.88	3.50	3.58	1.84	5.28	2.31	1.44	0.55	0.069	0.4	0.5
3/4	2.27	3.88	4.10	2.08	5.79	2.50	1.44	0.55	0.072	0.7	0.8
1	2.63	4.25	4.56	2.34	6.55	3.05	1.85	0.66	0.076	1.1	1.2
1 1/4	3.06	4.63	5.15	2.65	7.16	3.28	1.85	0.70	0.100	2.0	2.2
1 1/2	3.67	5.00	5.87	3.13	8.13	3.60	2.41	0.88	0.078	2.5	2.7
2	4.48	6.00	6.73	3.68	9.30	3.95	2.41	0.82	0.082	4.3	4.7
2 1/2	5.63	7.00	8.23	4.66	11.26	4.90	3.07	1.00	0.085	11.7	—
3	6.51	7.50	9.60	5.67	12.87	5.28	3.07	0.94	0.090	12.2	—
4	8.15	9.00	11.28	6.46	14.70	6.64	4.03	1.19	0.090	18.2	—
6	8.15	11.00	30.78	24.78	34.80	6.64	4.03	1.19	0.125	31.8	—

CPVC Part Numbers

Size (inch)	Socket/Threaded ¹		Flanged	
	EPDM	FPM	EPDM	FPM
1/2	163 375 002	163 375 017	163 375 062	163 375 077
3/4	163 375 003	163 375 018	163 375 063	163 375 078
1	163 375 004	163 375 019	163 375 064	163 375 079
1 1/4	163 375 005	163 375 020	163 375 065	163 375 080
1 1/2	163 375 006	163 375 021	163 375 066	163 375 081
2	163 375 007	163 375 022	163 375 067	163 375 082

Pressure/Temperature PVC and CPVC

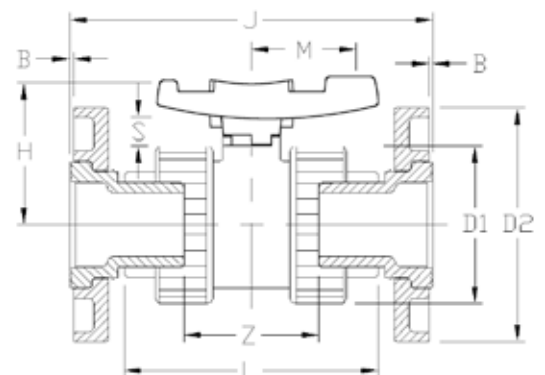
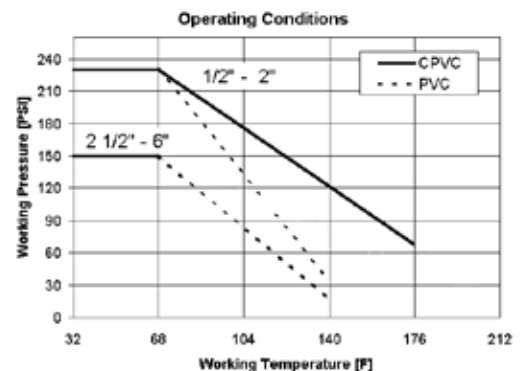

Type 375 True Union Ball Valve

Natural Polypropylene

Size range	20mm–90mm with Metric Socket Ends ½”–3” with PPro-Seal/Female NPT ends
Seals	FPM
Seat	PTFE

Natural PP Part Numbers

Size (mm)	Metric Socket	Size (inch)	Female NPT	PPro-Seal Electrofusion Socket and Female NPT
20	168 375 017	½	168 375 027	1088375005F
25	168 375 018	¾	168 375 028	1088375007F
32	168 375 019	1	168 375 029	1088375010F
40	168 375 020	1¼	168 375 030	N/A
50	168 375 021	1½	168 375 031	1088375015F
63	168 375 022	2	168 375 032	1088375020F
90	168 375 024	3		1088375030F

Specification

Ball valves shall be of True Union design with two-way blocking capability. Valves shall have a blow out proof stem with double stem seals. All O-rings shall be FPM and the valve seats shall be PTFE with an elastomeric backing of the same material as the valve seats. The valve shall be of floating ball design with full Schedule 80 bore. All ball valves shall have an adjustable seat carrier that can be adjusted or removed using the valve handle as a spanner wrench. The material

will be natural virgin copolymer polypropylene with no added plasticizers, pigments or re-grind that meets the requirements of ASTM D4101 and is compliant with FDA 21.CFR 177.1520 Sections A1, B & C. The valve Type 375 shall have a pressure rating up to 150 psi at 68°F. All valves shall be packaged in containers at the point of manufacturing to preserve cleanliness, as supplied by George Fischer, Inc., Tustin, CA or George Fischer Sloane, Inc., Little Rock, AR.

Pressure/Temperature Natural PP

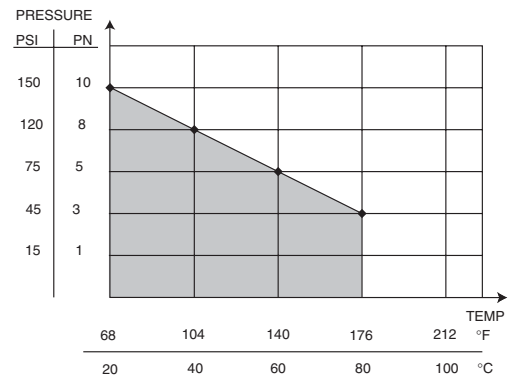

Dimensions Natural PP

Size mm	Size inch	D1	M	L Metric Socket	L Female NPT	L PPro-Seal	Z Metric Socket	Z FNPT/ PPro-Seal
20	½	1.88	1.44	3.01	3.58	3.86	1.77	1.84
25	¾	2.27	1.44	3.50	4.10	4.37	2.03	2.08
32	1	2.63	1.85	4.01	4.56	4.86	2.34	2.34
40	1¼	3.06	1.85	4.68	5.15	N/A	2.70	2.65
50	1½	3.67	2.41	5.50	5.87	5.87	3.10	3.13
63	2	4.48	2.41	6.59	6.73	6.73	3.65	3.68
90	3	6.51	3.07	9.60	N/A	9.60	5.67	5.67

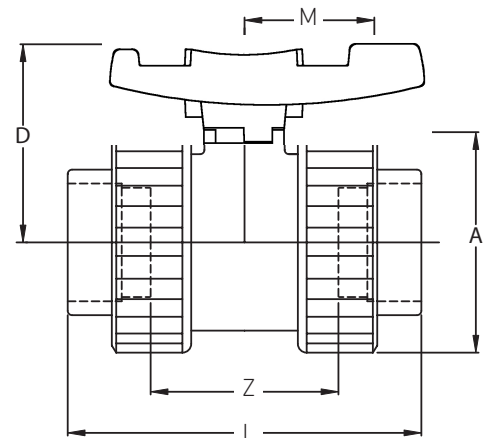

Type 375 True Union Ball Valve

PVC, CPVC, Natural PP

CV and Torque Values

Size mm	Size inch	CV	Torque ft-lb
20	1/2	15	0.37
25	3/4	21	1.11
32	1	55	1.84
40	1 1/4	81	4.06
50	1 1/2	126	5.16
63	2	245	7.38
	2 1/2	364	14.75
90	3	490	19.18
	4	700	20.65
	6	700	20.65

Type 375 Spare Parts

Size	PTFE/EPDM Seal set	PTFE/FPM Seal set	PVC Socket Ends	PVC Threaded Ends	Handle
3/8"	161 375 402	161 375 417	161 375 427	161 375 437	161 490 900
1/2"	161 375 403	161 375 418	161 375 428	161 375 438	161 490 900
3/4"	161 375 404	161 375 419	161 375 429	161 375 439	161 490 901
1"	161 375 405	161 375 420	161 375 430	161 375 440	161 490 902
1 1/4"	161 375 406	161 375 421	161 375 431	161 375 441	161 490 903
1 1/2"	161 375 407	161 375 422	161 375 432	161 375 442	161 490 904
2"	161 375 408	161 375 423	161 375 433	161 375 443	161 490 905
2 1/2"	161 375 409	161 375 424	161 375 434		161 490 906
3"	161 375 410	161 375 425	161 375 435		161 490 907
4"	161 375 411	161 375 426	161 375 436		161 490 908
6"	161 375 411	161 375 426			161 490 908

GF Piping Systems

2882 Dow Avenue, Tustin, CA 92780-7258

Tel. (714) 731-8800, Toll Free (800) 854-4090, Fax (714) 731-6201

e-mail: us.ps@georgfischer.com

www.gfpiping.com

The technical data is not binding. They neither constitute expressly warranted characteristics nor guaranteed properties nor a guaranteed durability. They are subject to modification. Our General Terms of Sale apply.

Argentina/Southern South America

Georg Fischer Central Plastics
Sudamérica S.R.L.
Buenos Aires, Argentina
Phone +5411 4512 02 90
gfcentral.ps.ar@georgfischer.com

Australia

George Fischer Pty Ltd
Riverwood NSW 2210 Australia
Phone +61(0)2 9502 8000
australia.ps@georgfischer.com
www.georgfischer.com.au

Austria

Georg Fischer
Rohrleitungssysteme GmbH
3130 Herzogenburg
Phone +43(0)2782 856 43-0
austria.ps@georgfischer.com
www.georgfischer.at

Belgium/Luxembourg

Georg Fischer NV/SA
1070 Bruxelles/Brüssel
Phone +32(0)2 556 40 20
be.ps@georgfischer.com
www.georgfischer.be

Brazil

Georg Fischer Ltda.
04795-100 São Paulo
Phone +55(0)11 5525 1311
br.ps@georgfischer.com
www.georgfischer.com.br

Canada

Georg Fischer Piping Systems Ltd
Mississauga, ON L5T 2B2
Phone +1(905)670 8005
Fax +1(905)670 8513
ca.ps@georgfischer.com
www.georgfischer.ca

China

Georg Fischer
Piping Systems Ltd Shanghai
Pudong, Shanghai 201319
Phone +86(0)21 58 13 33 33
china.ps@georgfischer.com
www.georgfischer.cn

Denmark/Iceland

Georg Fischer A/S
2630 Taastrup
Phone +45 (0)70 22 19 75
info.dk.ps@georgfischer.com
www.georgfischer.dk

Finland

Georg Fischer AB
01510 VANTAA
Phone +358 (0)9 586 58 25
Fax +358 (0)9 586 58 29
info.fi.ps@georgfischer.com
www.georgfischer.fi

France

Georg Fischer SAS
95932 Roissy Charles de Gaulle Cedex
Phone +33(0)1 41 84 68 84
fr.ps@georgfischer.com
www.georgfischer.fr

Germany

Georg Fischer GmbH
73095 Albershausen
Phone +49(0)7161 302-0
info.de.ps@georgfischer.com
www.georgfischer.de

India

Georg Fischer Piping Systems Ltd
400 076 Mumbai
Phone +91 224007 2001
in.ps@georgfischer.com
www.georgfischer.in

Italy

Georg Fischer S.p.A.
20063 Cernusco S/N (MI)
Phone +3902 921 861
it.ps@georgfischer.com
www.georgfischer.it

Japan

Georg Fischer Ltd
556-0011 Osaka,
Phone +81(0)6 6635 2691
jp.ps@georgfischer.com
www.georgfischer.jp

Korea

Georg Fischer Piping Systems
271-3 Seoheon-dong Bundang-gu
Seongnam-si, Gyeonggi-do
Seoul 463-824
Phone +82 31 8017 1450
Fax +82 31 8017 1454
kor.ps@georgfischer.com
www.georgfischer.kr

Malaysia

George Fischer (M) Sdn. Bhd.
40460 Shah Alam, Selangor Darul Ehsan
Phone +60 (0)3 5122 5585
my.ps@georgfischer.com
www.georgfischer.my

Mexico/Northern Latin America

Georg Fischer S.A. de C.V.
Apodaca, Nuevo Leon
CP66636 Mexico
Phone +52 (81)1340 8586
Fax +52 (81)1522 8906
mx.ps@georgfischer.com
www.georgfischer.mx

Middle East

Georg Fischer
Piping Systems [Switzerland] Ltd.
Dubai, United Arab Emirates
Phone +971 4 289 49 60
gcc.ps@georgfischer.com
www.export.georgfischer.com

Netherlands

Georg Fischer N.V.
8161 PA Epe
Phone +31(0)578 678 222
nl.ps@georgfischer.com
www.georgfischer.nl

Norway

Georg Fischer AS
1351 Rud
Phone +47(0)67 18 29 00
no.ps@georgfischer.com
www.georgfischer.no

Poland

Georg Fischer Sp. z o.o.
05-090 Sekocin Nowy
Phone +48(0)22 31 31 0 50
poland.ps@georgfischer.com
www.georgfischer.pl

Romania

Georg Fischer
Piping Systems [Switzerland] Ltd.
020257 Bucharest - Sector 2
Phone +40(0)21 230 53 80
ro.ps@georgfischer.com
www.export.georgfischer.com

Russia

Georg Fischer
Piping Systems [Switzerland] Ltd.
Moscow 125047
Tel. +7 495 258 60 80
ru.ps@georgfischer.com
www.georgfischer.ru

Singapore

George Fischer Pte Ltd
528 872 Singapore
Phone +65(0)67 47 06 11
sgp.ps@georgfischer.com
www.georgfischer.sg

Spain/Portugal

Georg Fischer S.A.
28046 Madrid
Phone +34(0)91 781 98 90
es.ps@georgfischer.com
www.georgfischer.es

Sweden

Georg Fischer AB
117 43 Stockholm
Phone +46(0)8 506 775 00
info.se.ps@georgfischer.com
www.georgfischer.se

Switzerland

Georg Fischer
Rohrleitungssysteme [Schweiz] AG
8201 Schaffhausen
Phone +41(0)52 631 30 26
ch.ps@georgfischer.com
www.piping.georgfischer.ch

Taiwan

Georg Fischer Piping Systems
San Chung City, Taipei Hsien
Phone +886 2 8512 2822
Fax +886 2 8512 2823
www.georgfischer.tw

United Kingdom/Ireland

Georg Fischer Sales Limited
Coventry, CV2 2ST
Phone +44(0)2476 535 535
uk.ps@georgfischer.com
www.georgfischer.co.uk

USA/Caribbean

Georg Fischer LLC
Tustin, CA 92780-7258
Phone +1(714) 731 88 00
Toll Free 800 854 40 90
us.ps@georgfischer.com
www.gfpiping.com

Vietnam

George Fischer Pte Ltd
136E Tran Vu, Ba Dinh District, Hanoi
Phone +84 4 3715 3290
Fax +84 4 3715 3285

International

Georg Fischer
Piping Systems [Switzerland] Ltd.
8201 Schaffhausen/Switzerland
Phone +41(0)52 631 30 03
Fax +41(0)52 631 28 93
info.export@georgfischer.com
www.export.georgfischer.com